



OWNER'S MANUAL

Soco TS1200R

Soco TS800R



Version 1.0
May 2017

Congratulations on purchasing your Soco electric motorcycle. We wish you an enjoyable and safe riding experience.

For your safety and comfort, we recommend that you read carefully the whole of this manual before using the motorcycle. If you have any questions, you should contact either Vmoto UK using the details below, or a dealer authorised by Vmoto UK.

The contact details for Vmoto UK are:

Telephone: 0800 133 7304

Email: info@vmoto-uk.com

Address: Vmoto UK Distribution Limited
29 Shand Street, London SE1 2ES

You should always follow the instructions, maintenance and riding requirements set out in this manual and have after-sales servicing carried out by an authorised dealer at the correct time. Failure to do so carries a risk of serious injury or death.

Before riding, take time to get acquainted with your motorcycle and how it works. To protect yourself and your investment, you should take responsibility for keeping your motorcycle well maintained. Scheduled servicing, pre-ride and other periodic checks detailed in this manual are a must.

1. Before using your motorcycle

- 1.1 Your motorcycle should be assembled by a properly qualified motorcycle mechanic at a dealer authorised by Vmoto UK.
- 1.2 You should undertake all training and certification that is legally required to ride your motorcycle. Also, if it's your first time riding this type of motorcycle, you should test in a quiet area away from traffic.
- 1.3 Ensure that you know about and obey all traffic laws and regulations.
- 1.4 Always use appropriate clothing, including armoured jacket and trousers, motorcycling boots, gloves and a properly-fitted helmet.

2. Riding style and safety

- 2.1 Ride with foresight and consideration for other road users. Always keep both hands on the handlebars while riding and turn the throttle slowly.
- 2.2 Never ride when under the influence of alcohol or drugs which may affect riding capability.
- 2.3 Ride with exceptional care on bumpy, loose or wet surfaces.
- 2.4 Pay attention to any unusual noises or handling of the motorcycle. If in doubt, check it out.
- 2.5 Always undertake the pre-ride checks mentioned in this owner's manual.
- 2.6 The motorcycle has a side stand. Ensure that the motorcycle is on an even, stable surface before using the stand.
- 2.7 Never use your mobile telephone or do anything else which may distract you from riding or from other road users.
- 2.8 Always service your motorcycle at an authorised Vmoto dealer in accordance with the service schedule set out in this owner's manual.

3. Vehicle schematics

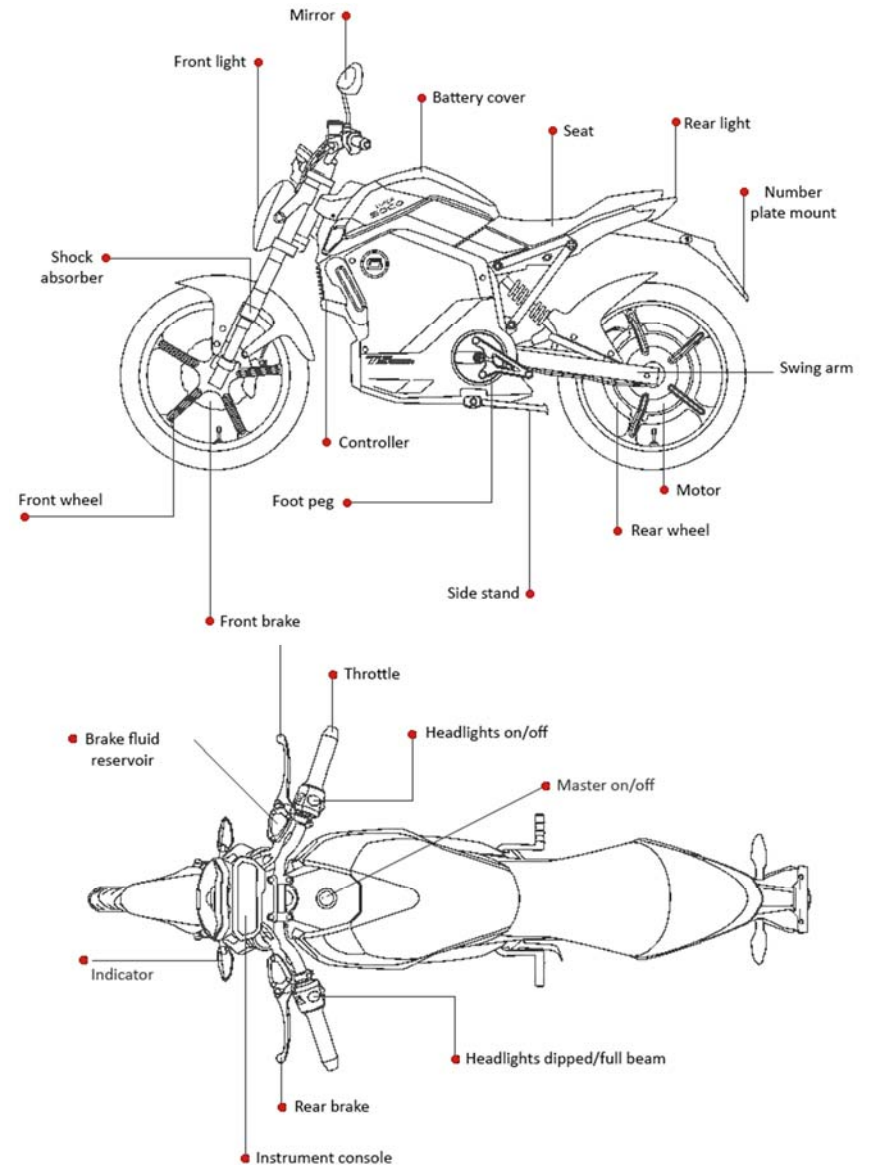

4. Instrument cluster

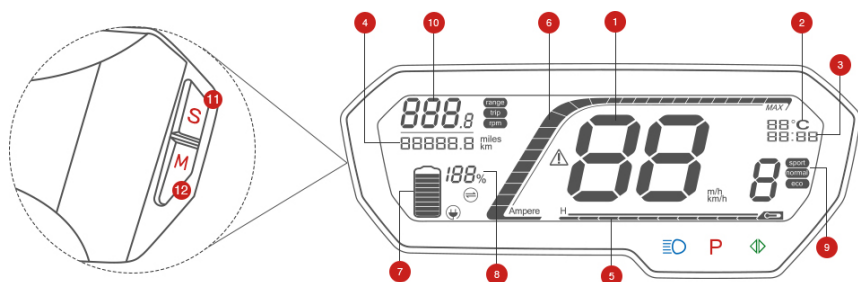

- 1 Speed display / fault code** - Displays the current speed or a fault code if there is a fault
- 2 Ambient temperature** - Displays the current ambient temperature
- 3 Clock** - Displays the clock
- 4 Total mileage** - Show the total mileage of the vehicle. To clear the trip, press the button labelled M on the rear of the instrument cluster
- 5 Controller temperature** - Displays the current operating temperature
- 6 Real-time current** - Displays the current output current
- 7 / 8 Battery meter** - Displays the current battery level
- 9 Gear display** - Displays the current gear (eco = 1, normal = 2, sport = 3)
- 10 Mileage / trip / RPM** – press button S to toggle

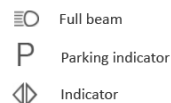
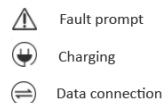

5. Handle switches

5.1 Left hand side

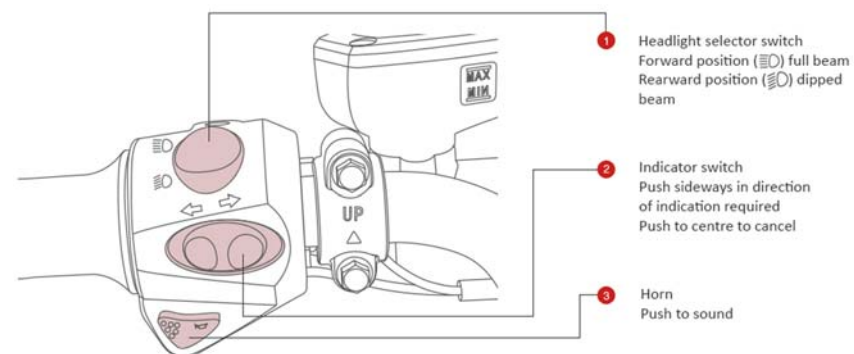

- 1 Headlight selector switch**
Forward position (☀) full beam
Rearward position (☾) dipped beam
- 2 Indicator switch**
Push sideways in direction of indication required
Push to centre to cancel
- 3 Horn**
Push to sound

5.2 Right hand side

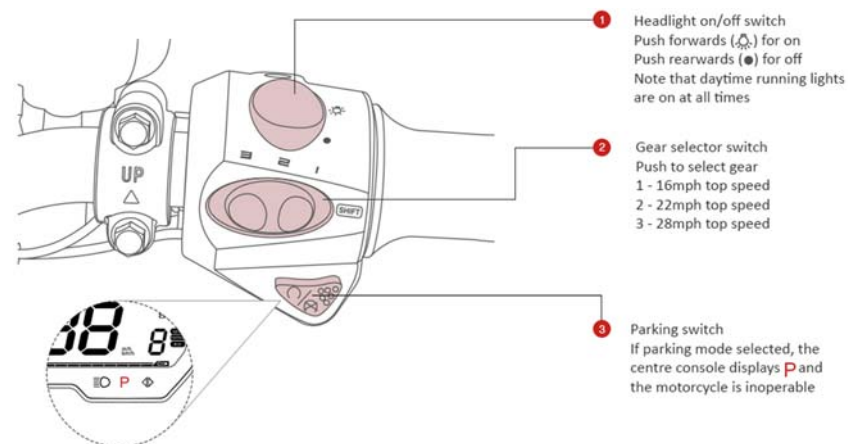

- 1 Headlight on/off switch**
Push forwards (☀) for on
Push rearwards (☾) for off
Note that daytime running lights are on at all times
- 2 Gear selector switch**
Push to select gear
1 - 16mph top speed
2 - 22mph top speed
3 - 28mph top speed
- 3 Parking switch**
If parking mode selected, the centre console displays P and the motorcycle is inoperable

6. Starting and locking

6.1 Switching on

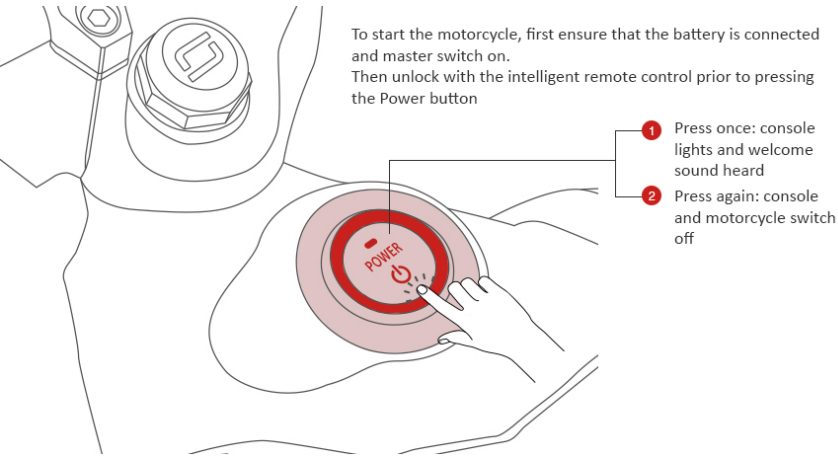

6.2 Intelligent key fob

The Soco is equipped with an intelligent keyless remote control
Two fobs are supplied with the motorcycle and are required for operation

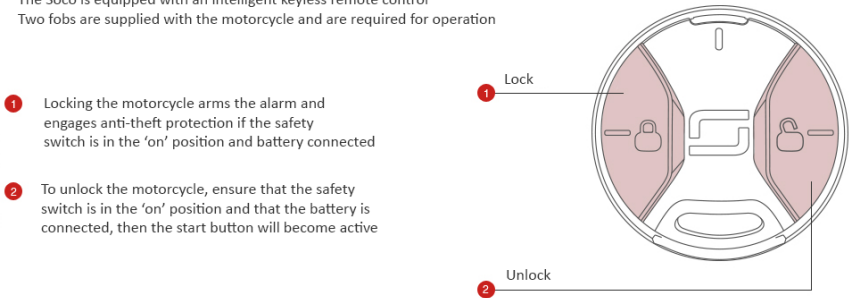

6.3 Physical steering lock

The steering lock is on the right of the motorcycle, next to the front forks
To engage the steering lock, turn the key to the right, and to disengage turn the key to the left

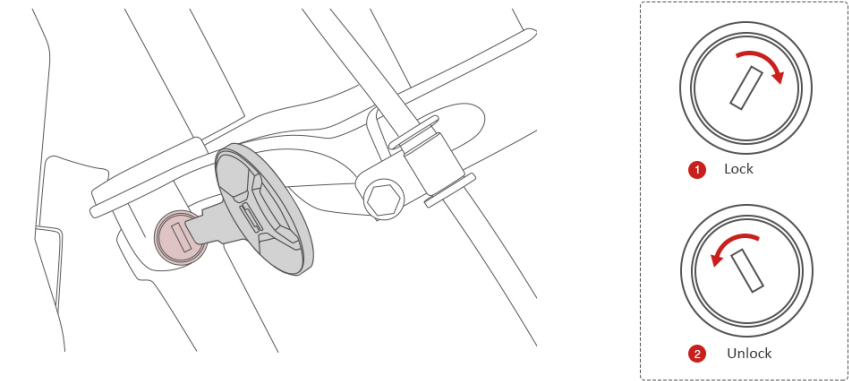

6.4 Safety switch

The safety switch is located under the cover and to the left hand side. It is accessible when the tray is in place
To switch on, push the switch forwards. To switch off, pull it backwards

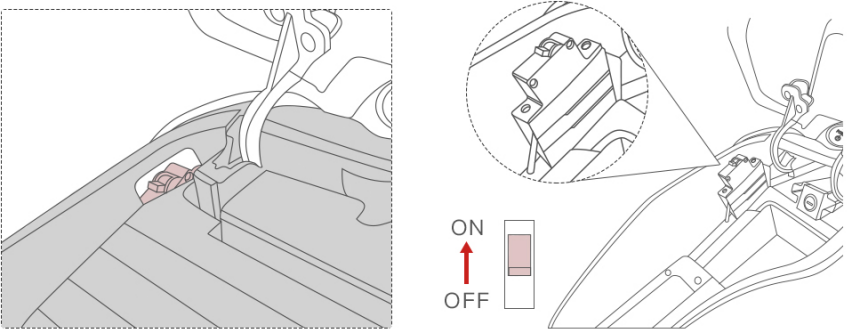

7. Front box / battery compartment and seat

7.1 Accessing front box / battery compartment

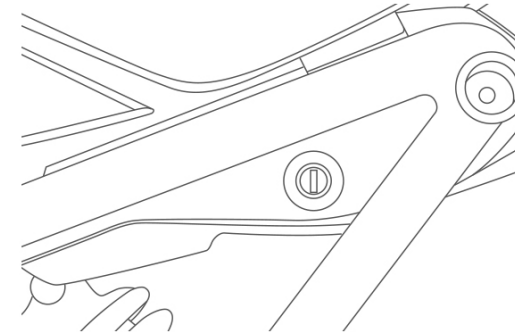
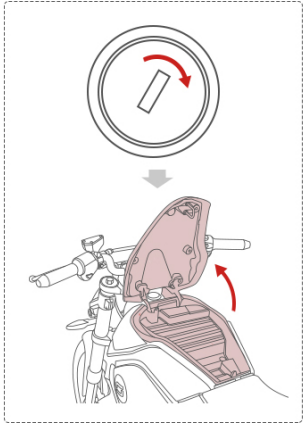

To open the front box / battery compartment, insert the key into the slot on the side of the motorcycle and turn to the right

7.2 Seat removal

- 1 To unlock the seat, insert the key into the slot on the side of the motorcycle and turn to the left

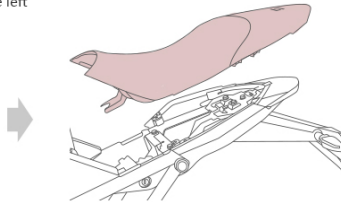

- 2 Pull the seat rearwards and in an upwards direction to remove it

8. Adjusting the foot pegs

The Soco has adjustable foot pegs to take account of riders of different heights - to adjust the foot pegs

1. Undo the hex bolt at the bottom of the footrest
2. Move the foot peg to the desired position (always have foot pegs at the same height)
3. Tighten the hex bolt, making sure it is secure

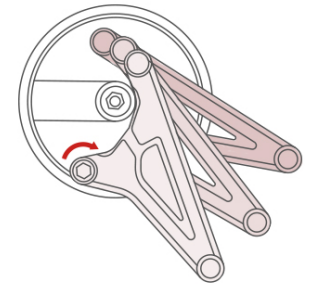
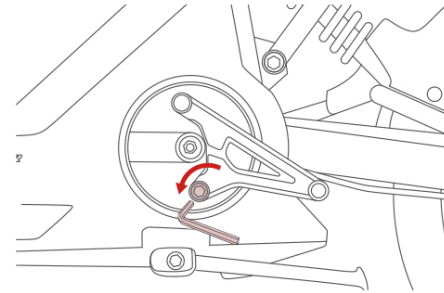

9. Pre-ride checks

- 9.1 Check tyre inflation (see paragraph 14.4), tread and wear and ensure no foreign objects are present. If tyres are worn or punctured, they must be replaced immediately.
- 9.2 Check brake operation and levels of brake fluid (on the handlebars next to the brake levers). Make sure that discs and pads are not worn or damaged and that the disc is not warped.
- 9.3 Move the steering from side to side, ensuring that the movement is smooth and not loose and that there is an equal turn angle in both directions.
- 9.4 Ensure charge level is sufficient for the journey. Do not start a ride with less than 20% battery.
- 9.5 While the motorcycle is off or in parking mode, check that throttle operation is smooth.
- 9.6 Check operation of headlights (dipped and full beam), indicators (front and rear) and horn.
- 9.7 Ensure that there are no error messages showing (see paragraph 15).

9.8 Ensure that you are wearing a helmet and appropriate motorcycle clothing.

10. Riding

10.1 Ensure that the motorcycle is unlocked and press the Start button. While sitting on the motorcycle, retract the side stand.

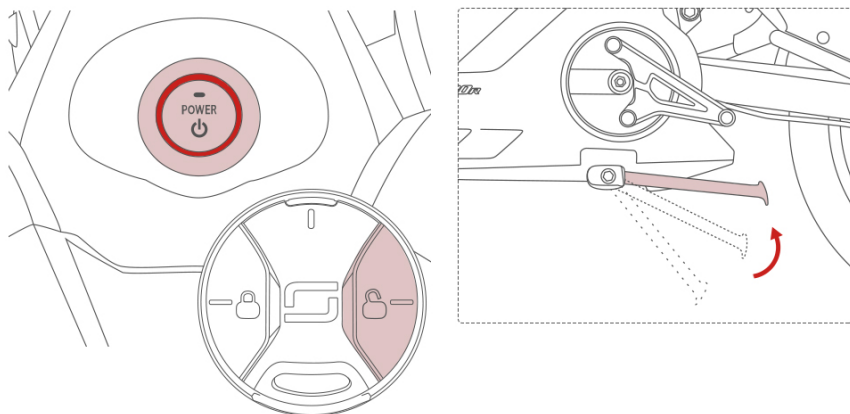

10.2 When ready to pull away, disengage parking mode so that the light no longer shows

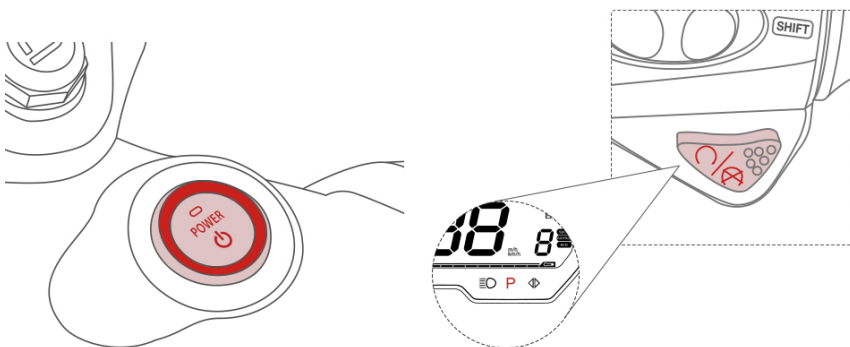

10.3 To pull away, gently twist the throttle towards you

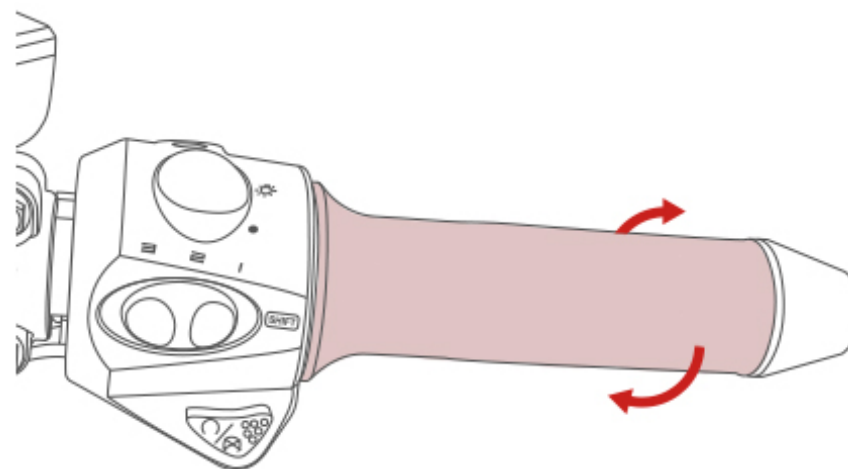

11. Loading

11.1 For storage, only use either the spare battery compartment or the tray on top of the battery compartment. The maximum loading of a motorcycle is 149kg, including rider, passenger and cargo.

11.2 The motorcycle is certified for a maximum of 2 people and the loading above. **Overloading is extremely unsafe.**

12. Battery

12.1 For the first 3 charges, ensure that the motorcycle is fully charged. Also, make sure that the motorcycle receives a full charge at least every 2 months.

12.2 The charger will stop automatically. It is not possible to reverse the polarity. Charging for a long time / overnight will not damage the battery or the charger. However the motorcycle should not be left plugged in for more than 24 hours.

12.3 A full charge takes approximately 7-8 hours.

12.4 After completing a ride, charge the motorcycle to ensure full battery for the next ride.

12.5 If storing the motorcycle, ensure that the safety switch is in the off position and that the battery is unplugged. Preferably, remove the battery from the motorcycle for storage and ensure charged at least every two months. Failure to do so will deplete the battery and may lead to it needing replacement. Recharge the battery after storage.

12.6 Charging method 1 – battery in

Plug the charger lead into the socket on the side of the motorcycle, then plug the charger into the wall and turn on the power.

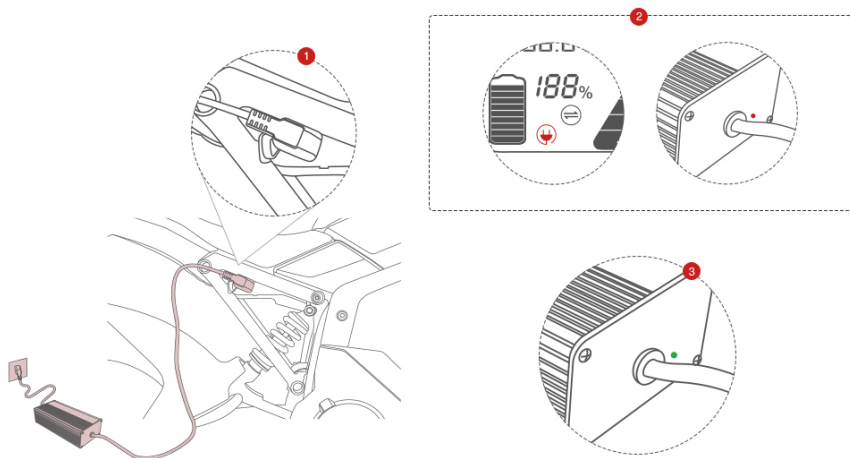

12.7 Charging method 2 – battery out

Open the battery compartment cover and switch the safety switch into the off position, prior to lifting out the tray

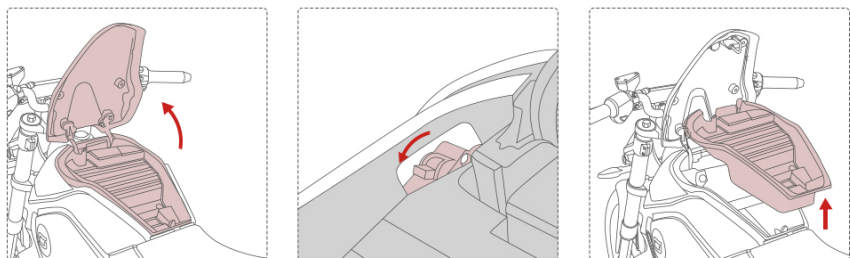

Disconnect the battery plug from the cable in the battery compartment

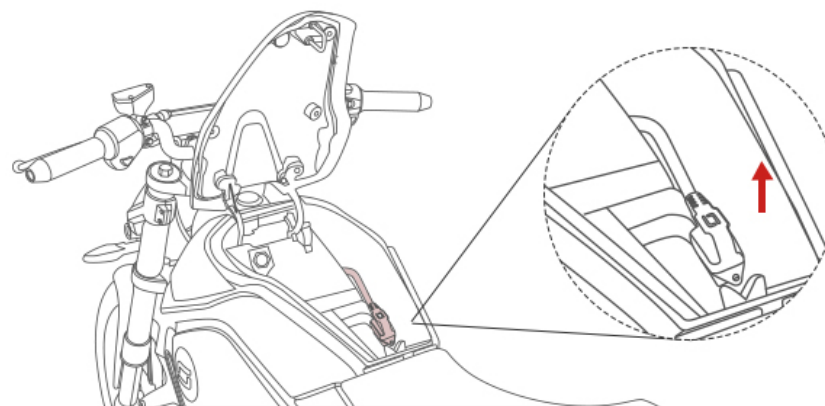

Insert the key into the battery lock and turn clockwise while gently lifting the battery from the motorcycle, taking care not to strain and cause injury, as the battery is heavy

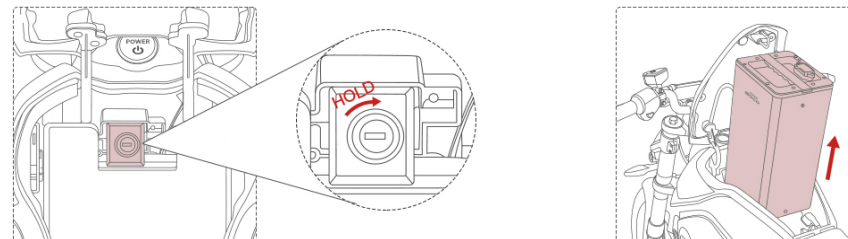

Plug the charger lead into the battery socket, then plug the charger into the AC socket and turn on the power

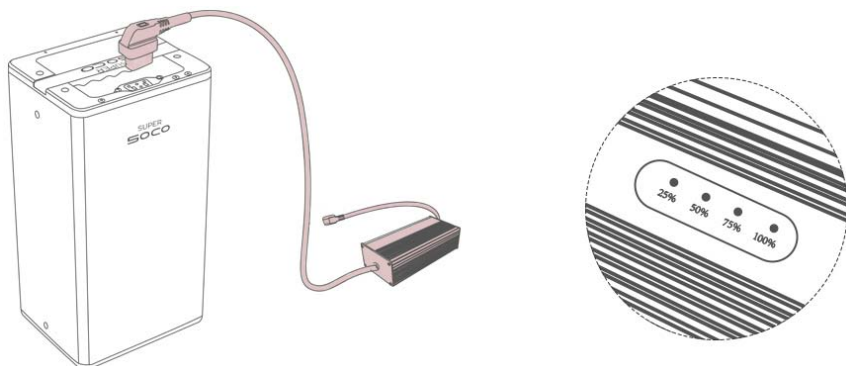

Charging is complete when all lights show solid green

12.8 Never leave the motorcycle with a depleted battery as this can cause the battery voltage to dip below minimum and require replacement.

12.9 Using the motorcycle with a depleted battery will shorten the life of the battery and can make the battery inoperable (requiring replacement).

12.10 Do not attempt to modify or disassemble the battery, or perform any diagnostics. This is extremely dangerous and can result in fire and explosion.

12.11 Do not charge the motorcycle with the ignition turned on.

12.12 The operational temperature range for the battery is -20°C to 45°C. The temperature range for charging the battery is 0°C to 45°C. The temperature range for storage of the battery is -20°C to 35°C. Using the motorcycle or charging or storing the battery outside of the stated ranges will damage the battery. If the ambient temperature is outside the stated range for operation or charging, move the motorcycle to a place where it will cool / warm and do not use or charge until the motorcycle temperature is within the stated range.

13. Electrical safety

13.1 Only use the original charger and cables supplied with the motorcycle. Use of other chargers or cables is dangerous. Replace fuses in the charger plug with the same type.

13.2 Only once the charger is connected to the motorcycle, plug the charger into a 13A outlet.

13.3 Do not plug the other end into the 13A outlet until the charging cable is connected to the motorcycle.

13.4 The charger lights indicate the level of charge in the battery.

13.5 No adaptation should be required to domestic wiring although ensure that miniature circuit breakers (MCBs) are fitted at the distribution box. If in doubt, ask an electrician.

13.6 Never charge the motorcycle in the wet, or in damp conditions. Never leave extension cables outside or on the ground. Using any electrical appliance (including your motorcycle charger) in the wet is extremely dangerous and can lead to serious injury or death.

13.7 If the motorcycle is involved in an accident, and the battery box is compromised, there is a very small risk of fire and explosion. The battery box is located between the wheels of the motorcycle.

13.8 If the motorcycle becomes hot to the touch, starts smoking or gives off a strange smell you should stop riding and move to a safe distance from the motorcycle before calling emergency services. Inform emergency services that the motorcycle uses lithium ion batteries.

14. Vehicle maintenance

14.1 You should clean your motorcycle regularly, using products specifically designed for motorcycles. Do not use rough or abrasive cleaning products as they will damage the finish.

14.2 Vehicles parked outside must be covered with a waterproof cover in order to protect from sun damage and water ingress.

14.3 Do not use high pressure cleaners. They can penetrate the seals and cause electrical faults. Cleaning with a high pressure cleaner is dangerous.

14.4 The only other user maintenance that should be carried out is charging and tyre inflation. The correct pressure for the tyres is:

(a) front: 20-25 PSI

(b) rear: 26-32 PSI

14.5 Low tyre pressure or worn tyres will affect range and handling.

14.6 All other mechanical issues or error messages should be referred to a dealer authorised by Vmoto UK. If an error message appears, in the first instance turn the motorcycle off and then on again using the safety switch.

15. Troubleshooting

Fault	Likely cause of fault	Action
The vehicle is dead and the start button does not light	1. The battery is not connected	1. Connect the battery
	2. The safety switch is in the off position	2. Move the safety switch to the on position
With the power on, upon opening the throttle, the motorcycle does not move	1. The battery is depleted	1. Charge the battery
	2. The side stand is out	2..Put the side stand away
	3. Parking mode is active	3. Deactivate parking mode
	4. The brake is on	4. Release the brake
	5. The throttle switch is faulty	5. Contact after sales care or dealer
	6. Controller plug is loose	6. Contact after sales care or dealer
	7. Controller fault	7. Contact after sales care or dealer
Slow speed or short range	1. Battery is low or depleted	1. Charge the battery
	2. Tyre pressures are too low	2. Check tyre pressures and inflate if necessary; riding

		with low tyre pressures also causes handling issues
	3. The motorcycle is overloaded	3. Decrease the load; this is dangerous
	4. The brakes require adjustment	4. Check brake pad wear and if necessary contact after sales care or dealer
	5. The battery is old or requires replacement	5. Replace the battery
The battery will not charge	1. Bad connection	1. Check the connections between the battery and the motorcycle and / or the charger
	2. Non-original charger is being used	2. Use the original charger; use of other chargers is dangerous
	5. The battery is old or requires replacement	5. Replace the battery
Console display 99	Controller communication failure	Contact after-sales care or dealer
Console display 98	Controller has suspended operation (owing to possible overcurrent, stall, undervoltage or overtemperature)	Stop for a while and attempt to start again
Console display 97	Controller power tube failure	Contact after sales care or dealer
Console display 96	Controller hall failure	Contact after sales care or dealer
Console display 95	Controller sensor fault	Contact after sales care or dealer
Console display 94	Battery communication failure	Please check whether the charging interface is connected, if not contact after sales care or dealer

Console display 93	Charge overcurrent	Stop charging and check the charger
Console display 92	Charge overvoltage	Stop charging and check the charger
Console display 91	Battery high temperature	Stop charging / stop riding
Console display 90	Battery discharge overcurrent	Stop riding immediately
Console display 89	Charging low temperature	Push motorcycle to a warm place and wait for it to warm up
Console display 88	Discharge low temperature	Push motorcycle to a warm place and wait for it to warm up
Console display 87	Network connection is abnormal	Contact after sales care or dealer
Console display 86	GPS connection exception	Contact after sales care or dealer

Delivery certificate

This certifies that a pre-delivery inspection has been carried out by an authorised dealer / Vmoto UK in accordance with PDI check sheets in force

<div>_____</div> <div>Signature of tester and dealer stamp</div> <div>_____</div> <div>Date</div>

Vehicle identification number (VIN):
Model name
Warranty version
Date of delivery
Dealer name and address

Service history

All of the inspections and services should be carried out either by Vmoto UK or a dealer authorised by Vmoto UK.

Inspections are due within 100 miles of when they are stated to be due. Inspections must be carried out at least annually, no matter what the distance ridden.

The mandatory checks to be carried out at each service are:

- Charge batteries (note battery guidelines) and check contacts
- Check tyre pressure and correct if necessary
- Check tyre wear and replace tyre(s) if necessary
- Check brake pads and discs and correct / replace if necessary
- Check all main screws against torque requirements
- Check screws, nuts and fastening points
- Check motor mountings, stand mountings, suspension struts, fork and handlebar bearing
- Check the functioning of front and rear suspension
- Check that all operating parts are in working order
- Check all lights
- Check directional stability, front and rear brakes and handlebar

<p>Inspection 500 miles</p> <p>miles: _____</p> <p>_____</p> <p>Date, signature, stamp</p>	<p>Inspection 3,500 miles</p> <p>miles: _____</p> <p>_____</p> <p>Date, signature, stamp</p>
<p>Inspection 6,500 miles</p> <p>miles: _____</p> <p>_____</p> <p>Date, signature, stamp</p>	<p>Inspection 9,500 miles</p> <p>miles: _____</p> <p>_____</p> <p>Date, signature, stamp</p>
<p>Inspection 12,500 miles</p> <p>miles: _____</p> <p>_____</p> <p>Date, signature, stamp</p>	<p>Inspection 15,500 miles</p> <p>miles: _____</p> <p>_____</p> <p>Date, signature, stamp</p>
<p>Inspection 18,500 miles</p> <p>miles: _____</p> <p>_____</p> <p>Date, signature, stamp</p>	<p>Inspection 21,500 miles</p> <p>miles: _____</p> <p>_____</p> <p>Date, signature, stamp</p>

Inspection 24,500 miles miles: _____ _____ Date, signature, stamp	Inspection 27,500 miles miles: _____ _____ Date, signature, stamp
Inspection 30,500 miles miles: _____ _____ Date, signature, stamp	Inspection 33,500 miles miles: _____ _____ Date, signature, stamp
Inspection 36,500 miles miles: _____ _____ Date, signature, stamp	Inspection 39,500 miles miles: _____ _____ Date, signature, stamp
Inspection 42,500 miles miles: _____ _____ Date, signature, stamp	Inspection 45,500 miles miles: _____ _____ Date, signature, stamp

Inspection 48,500 miles miles: _____ _____ Date, signature, stamp	Inspection 51,500 miles miles: _____ _____ Date, signature, stamp
Inspection 54,500 miles miles: _____ _____ Date, signature, stamp	Inspection 57,500 miles miles: _____ _____ Date, signature, stamp
Inspection 60,500 miles miles: _____ _____ Date, signature, stamp	Inspection 63,500 miles miles: _____ _____ Date, signature, stamp
Inspection 66,500 miles miles: _____ _____ Date, signature, stamp	Inspection 69,500 miles miles: _____ _____ Date, signature, stamp

<p>Odometer changed</p> <p>miles: _____</p> <p>_____</p> <p>Date, signature, stamp</p>	<p>Odometer changed</p> <p>miles: _____</p> <p>_____</p> <p>Date, signature, stamp</p>
<p>Odometer changed</p> <p>miles: _____</p> <p>_____</p> <p>Date, signature, stamp</p>	<p>Odometer changed</p> <p>miles: _____</p> <p>_____</p> <p>Date, signature, stamp</p>